

LEGEND

- Existing trees to be retained
- Existing trees to be removed
- Proposed tree plantings
- Proposed screen shrub plantings
- Proposed groundcover plantings
- Concrete path pavement
- Non slip tiles pavement
- Proposed garden bed
- Proposed turf area
- Concrete garden edge
- Concrete moisture barrier adjoining building

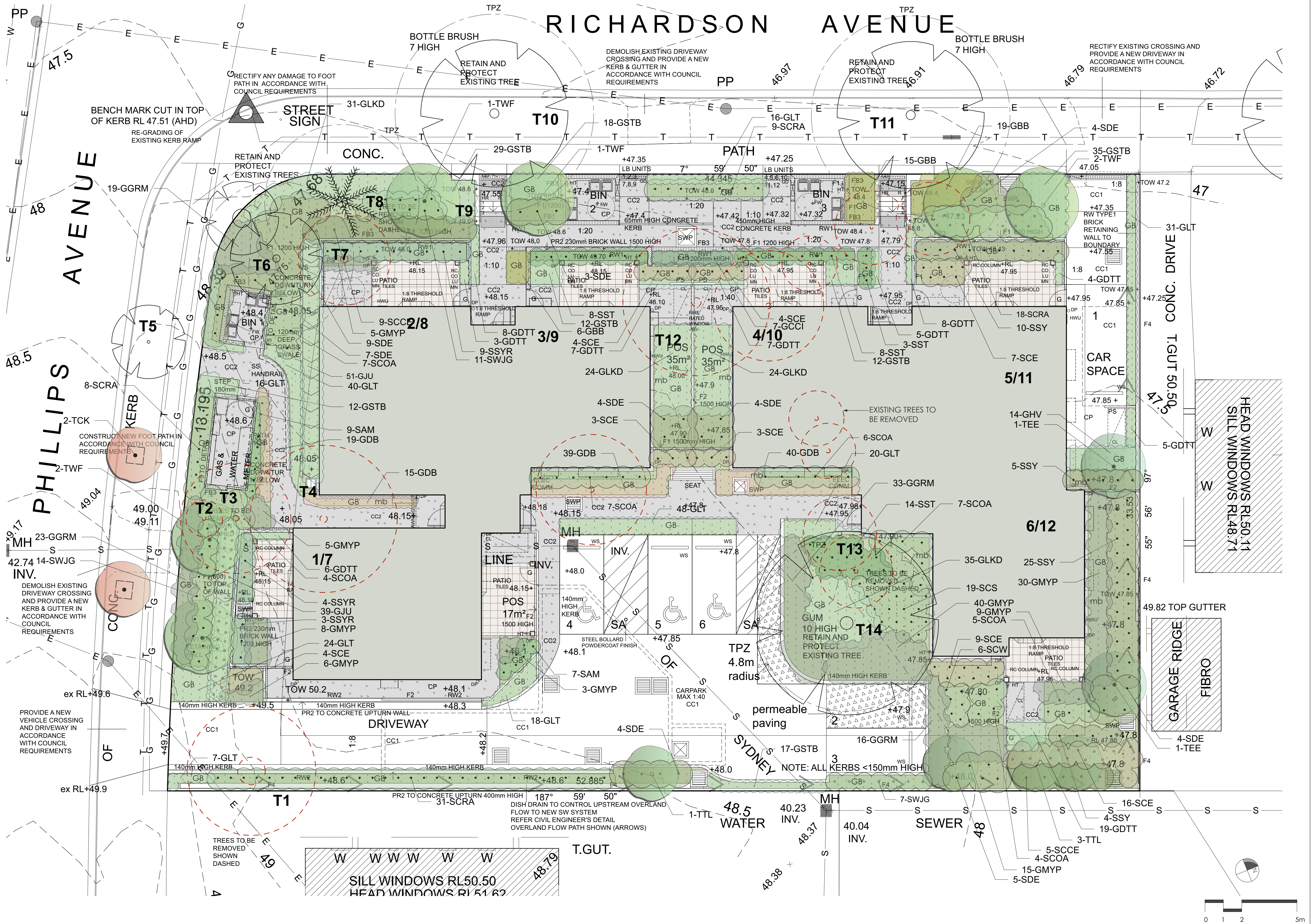

LOCKED BAG 5022
PARRAMATTA NSW 2124
PHONE No 1800 738 718
<https://www.dpie.nsw.gov.au/land-and-housing-corporation>

NOMINATED ARCHITECT:
Barry Rush & Associates Pty Ltd
Architects
Suite 25A, 2 Beattie Street, Balmain, NSW, 2041
Phone: (012) 8555 9028 Fax: (012) 9810 0161
Email: info@barryrush.com.au
www.barryrush.com.au

F 02/06/2022 DISH DRAIN AND OVERFLOW PATH ADDED
E 16/02/2022 SOUTHERN SNAILES ADDED
D 03/11/2021 PART 5 REVISION
C 25/10/2021 PART 5 RE-ISSUED
B 04/05/2021 FOR TENDER
REV DATE NOTATION/AMENDMENT
DO NOT SCALE DRAWINGS. CHECK ALL DIMENSIONS ON SITE.
FIGURED DIMENSIONS TAKE PRECEDENCE.

PROJECT MANAGER
LAND & HOUSING CORPORATION
PH (02) 8753 8000 FAX (02) 8753 8888
STRUCTURAL CONSULTANT
MECHANICAL CONSULTANT

HYDRAULIC CONSULTANT
ELECTRICAL CONSULTANT
LANDSCAPE CONSULTANT
GREENLAND DESIGN PTY LTD
PH 0403 164 188

PROJECT:
SENIORS DEVELOPMENT
21-23 PHILLIPS AVENUE & 5 RICHARDSON AVENUE
REGENTS PARK
LOTS 53, 54 & 55 IN DP35559

TITLE:
LANDSCAPE PLAN
FILE: 2227

STATUS:
PART 5 APPROVAL
DATE: 02/06/2022 SCALE: 1:100 PROJ: - PROJECT NO: BGJF2
DRAWN: CL CHECKED: GD
TYPE: LA SHEET: 1 of 2 REV: F

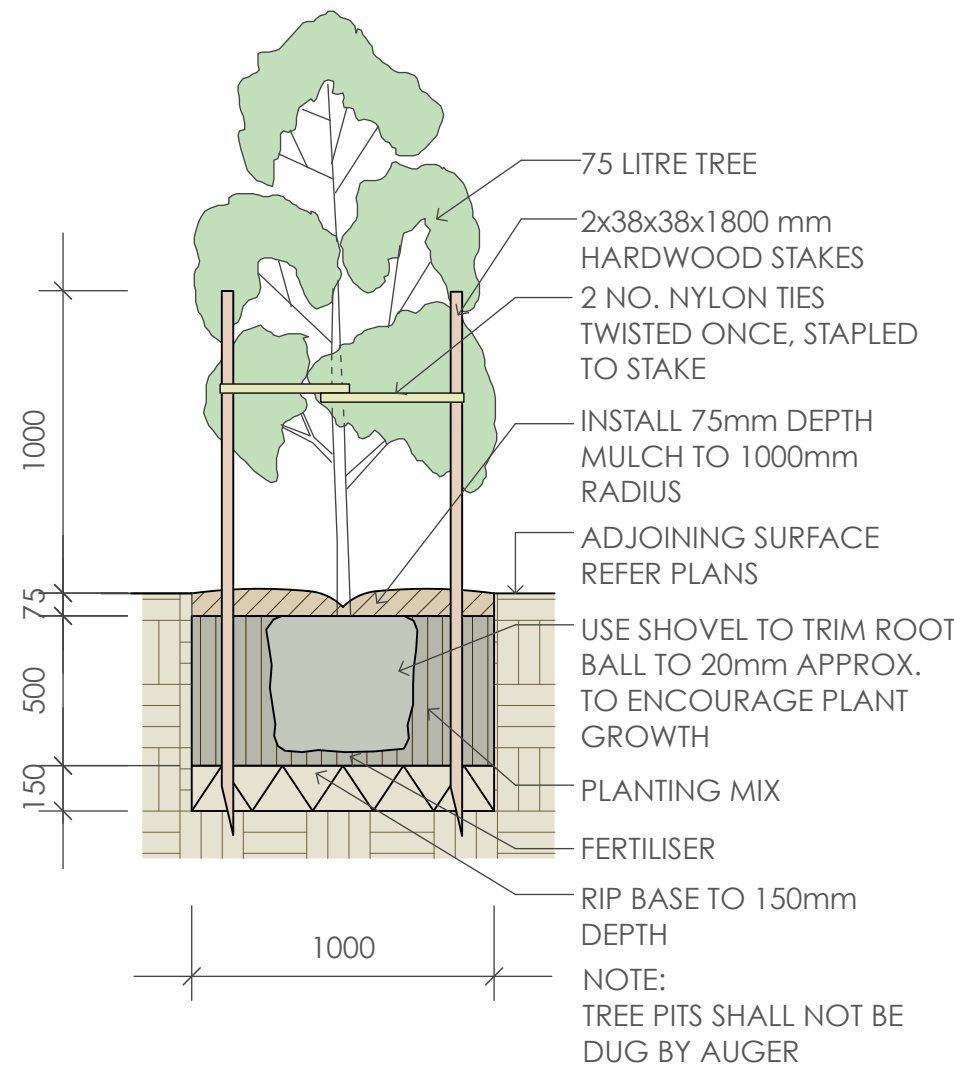

1 75 Litre Tree Planting
scale 1:25

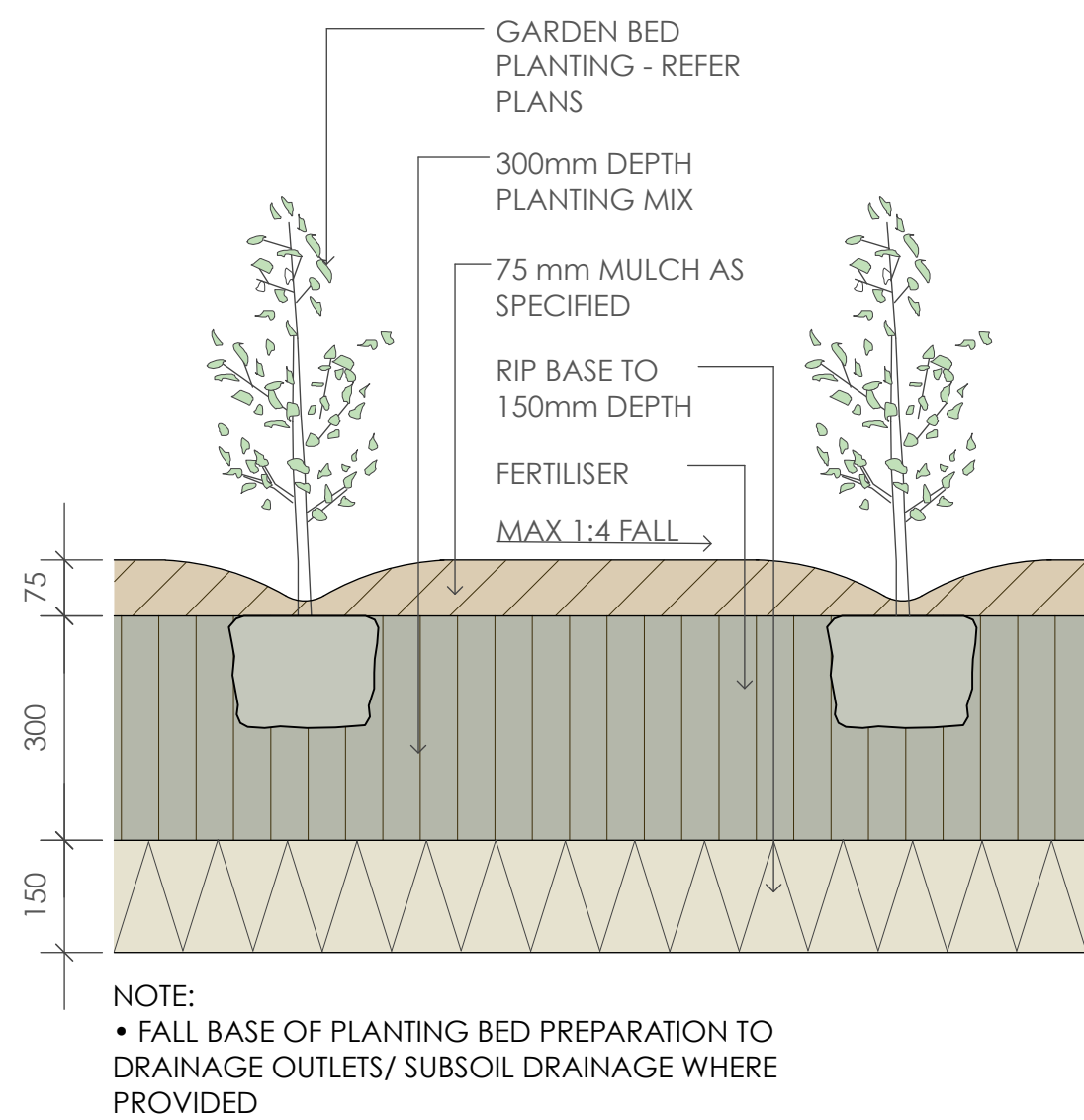

2 Planting Bed Detail
scale 1:10

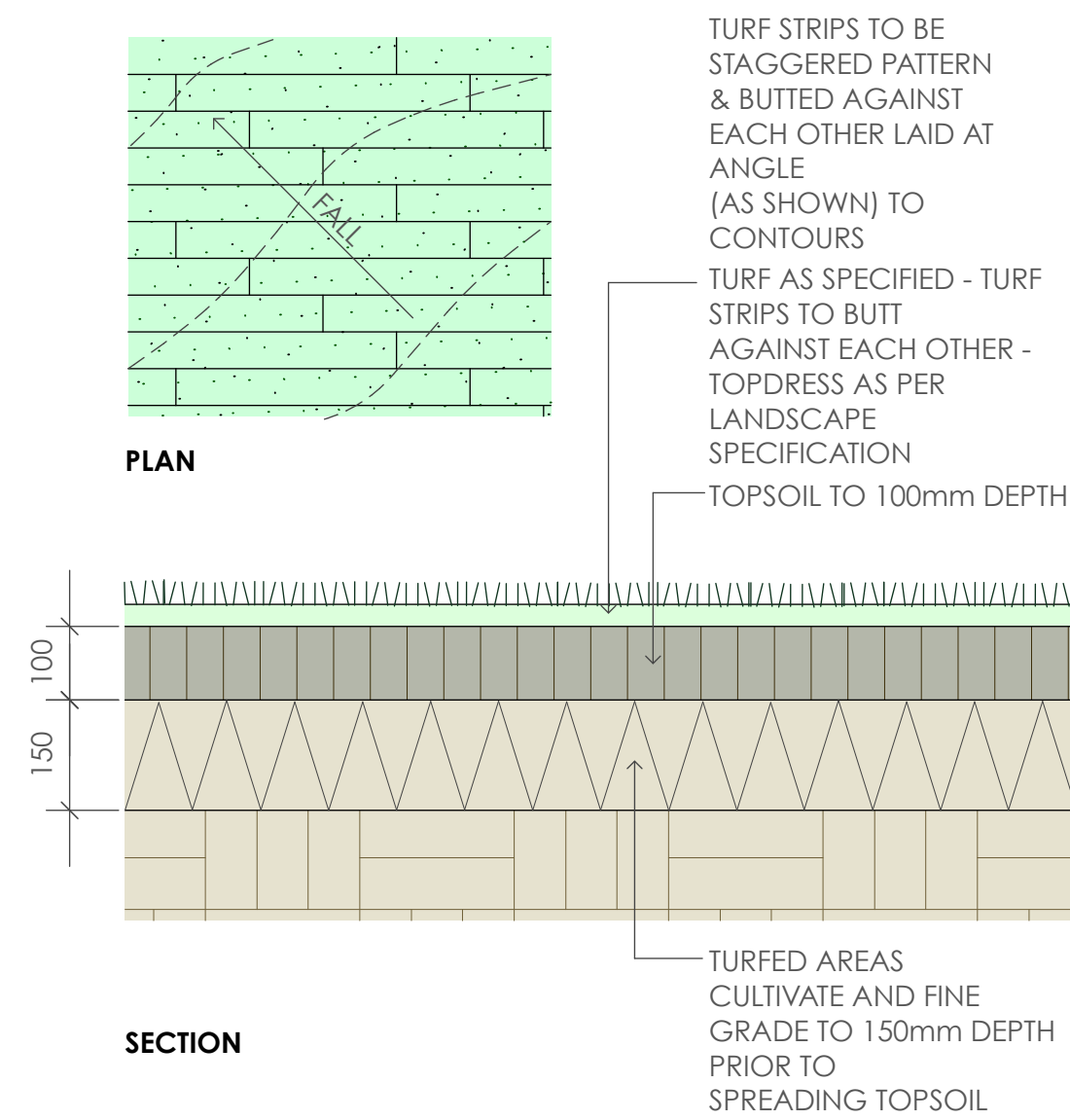

3 Turfing
scale as shown

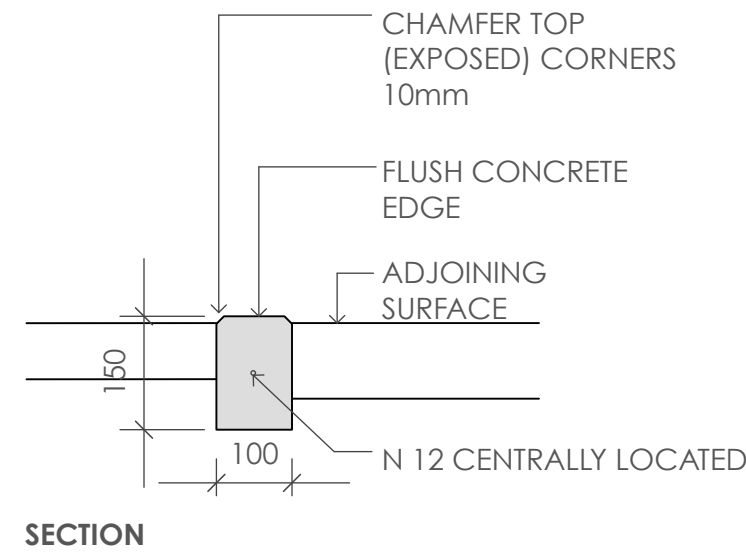

4 Concrete Edge
scale 1:10

| Plant Schedule | | | | | | | |
|----------------------|-----|---------------------------|---------------------------------------|---------|------------------|---------------|------------|
| ID | Qty | Common Name | Botanical Name | Size | Mature Height | Mature Spread | Native (N) |
| Trees | | | | | | | |
| TCK | 2 | Bottlebrush | Callistemon 'Kings Park Special' | 75Litre | 3 - 6m | 2.0 - 3.5m | N |
| TEE | 2 | Eumundi Quandong | Elaeocarpus eumundi | 75Litre | 6 - 8m | 3.5 - 6m | N |
| TTL | 4 | Water Gum | Tristaniopsis laurina 'Luscious' | 75Litre | 6 - 8m | 3.5 - 6m | N |
| TWF | 6 | Weeping Lilly Pilly | Waterhousia floribunda | 75Litre | 6 - 8m | 3.5 - 6m | N |
| Shrubs | | | | | | | |
| SAM | 16 | Alynn Magic | Acmena 'Alynn Magic' | 200mm | 0.6 - 0.8m | 0.6 - 0.8m | N |
| SCCE | 14 | Scarlet Bottlebrush | Callistemon citrinus 'Endeavour' | 200mm | 3 - 5m | 2.0 - 3.5m | N |
| SCE | 50 | Evening Glow Mirror Plant | Coprosma 'Evening Glow' | 200mm | 0.9 - 1.5m | 0.9 - 1.2m | N |
| SCOA | 40 | New Zealand Cabbage Tree | Cordyline australis 4m | 200mm | 3 - 4m | 1.0 - 2.0m | N |
| SCRA | 66 | Red Alert Bottle Brush | Callistemon 'Red Alert' | 200mm | 1.0 - 1.5m hedge | 2.0 - 3.0m | N |
| SCS | 19 | Narrow Palm Lily | Cordyline stricta congesta | 200mm | 1 - 2m | 0.8 - 1.0m | N |
| SCW | 6 | White Correa | Correa alba | 200mm | 0.9 - 1.5m | 0.9 - 1.2m | N |
| SDE | 44 | Gymea Lily | Doryanthes excelsa | 200mm | 1.5 - 2m | 1.2 - 2.0m | N |
| SST | 33 | Tiny Trev | Syzygium australe 'Tiny Trev' | 200mm | 0.5 - 0.8m | 0.6 - 0.8m | N |
| SSY | 44 | Cascade Lilly Pilly | Syzygium 'Cascade' | 200mm | 2 - 3m | 1.2 - 2.0m | N |
| SSYR | 16 | Resilience Lilly Pilly | Syzygium 'Resilience' | 200mm | 2 - 3m | 1.2 - 2.0m | N |
| SWJG | 32 | Jervis Gem | Westringia fruticosa 'Jervis Gem' | 200mm | 0.8 - 1.2m | 0.8 - 1.2m | N |
| Ground Covers | | | | | | | |
| GLT | 220 | Spiny-headed mat rush | Lomandra longifolia 'Tanika' | 150mm | 0.45 - 0.6m | 0.6 - 0.9m | N |
| GDIT | 72 | Flax Lily | Dianella tasmanica 'Tasred' | 150mm | 0.4 - 0.5m | 0.4 - 0.5m | N |
| GSTB | 135 | Trident Blue | Senecio Trident Blue | 150mm | 0.4 - 0.5m | 0.4 - 0.5m | N |
| GCCI | 7 | Cousin It | Casuarina 'Cousin It' | 150mm | 0.10 - 0.15m | 0.8 - 1.0m | N |
| GLKD | 114 | Katrinus Deluxe Mat-Rush | Lomandra longifolia 'Katrinus Deluxe' | 150mm | 0.75 - 0.9m | 0.9 - 1.2m | N |
| GHV | 14 | Meema | Hardenbergia violacea 'Meema' | 150mm | 0.4 - 0.6m | 1.5 - 2.0m | N |
| GJU | 90 | Tussock Rush | Juncus usitatus | 150mm | 0.5 - 0.7m | 0.8 - 1.0m | N |
| GDB | 113 | Flax Lily | Dianella tasmanica 'Blaze' | 150mm | 0.4 - 0.5m | 0.4 - 0.6m | N |
| GBB | 40 | Birthday Candle | Banksia spinulosa 'Birthday Candle' | 150mm | 0.45 - 0.6m | 0.9 - 1.2m | N |
| GMYP | 121 | Carpet Spreading Myoporum | Myoporum parvifolium 'Yareena' | 150mm | 0 - 0.1m | 2.0 - 3.0m | N |
| GGRM | 91 | Royal Mantle Grevillea | Grevillea 'Poorinda Royal Mantle' | 150mm | 0 - 0.1m | 2.0 - 3.0m | N |

SPECIFICATION NOTES

PLANTING MATERIALS

Planting Mix:

Planting mix for tree pit backfill shall be "Organic Garden Mix" consisting of

- 50% Black Soil
- 20% Coarse Sand
- 30% Organic Material

as available from Australian Native Landscapes, Phone: [02] 9450 1444, or approved equivalent. Samples shall be provided to the Superintendent prior to ordering or delivery to site. Any material delivered to site, that is rejected by the Superintendent, shall be removed by the contractor at his own expense. Minimum depths of mix to all planting bed areas is as specified on details.

Mulch:

Mulch to garden bed:

Mulch shall mean hardwood mulch (25mm grade), free from material derived from Privet, Willow, Poplar, Coral trees, or other noxious weeds. Any mulch exceeding the 25mm grade shall be rejected / removed from the site. Graded hardwood mulch to be supplied by Australian Native Landscapes Pty Ltd Phone (02) 9450 1444, or approved equivalent.

Spread mulch so that after settling, it is:

- smooth and evenly graded between design surface levels;
- flush with adjacent finished levels;
- of the required depths (75mm); and
- sloped towards the base of plant stems in plantation beds, but not in contact with the stem (not closer than 50mm in the case of gravel mulches).

Place after the preparation of the planting bed, planting and all other work.

Plant Material:

All plant material must be true to the species. No substitutes will be allowed. All plants shall be free of fungus and insect damage. All plants shall be healthy, well shaped, not soft or force grown and not root bound.

Plants are available from **Andreasens Green** wholesale nursery, contact Darren (02) 8777 4713, email darren@andreasensgreen.com.au or approved equivalent.

Turfed areas:

All new turfed areas are to be selected weed free Soft Leaf Buffalo. Turf shall be laid neatly butted with staggered joins, flush with adjacent surfaces and have even running falls to all drainage points. All new turfed area shall have a minimum 150mm depth of weed free top soil, placed and levelled prior to turfing.

PREPARATION AND HARDWORKS

Excavating for Spot Planting

To planting areas, excavate a hole for each plant large enough to provide not less than twice the depth and twice the diameter than the root ball of species to be planted.

Staking

Use durable hardwood, straight, free from knots or twists, pointed at one end. Drive stakes into the ground a minimum one third of their length, avoiding damage to the root system.

- 75 Litre trees in 2 x 38x38x1800mm Hardwood Stake with double Nylon tie
- TIES: Provide a 50mm wide Nylon webbing tie per stake, fixed securely to the stakes, one tie at half the height of the main stem and the other as necessary to stabilise the plant.

Concrete Edge / Moisture Barrier

MATERIALS: Concrete to be off white colour.

INSTALLATION: Supply and install 150 x 100mm (width) reinforced flush concrete kerb to locations as approved on site by the Superintendent. Provide flexible joints at maximum 3 metre intervals in colour to match concrete. Lightly expose aggregate through rinsing / sponging. Tool finish exposed edges with 10mm pencil round to prevent chipping.

MAINTENANCE / PLANT ESTABLISHMENT

Maintenance shall apply to all hard and soft landscape materials installed prior to the "handover" and acceptance by Principles Representative and the Site Superintendent. The maintenance period shall convenience at the granting of practical completion and shall extend for 12 months.

Maintenance shall consist of the following works:

- Follow a daily watering programme to be approved by Superintendent. Water all plants individually, twice per week or when necessary to ensure constant plant growth. Water all turf and native grassed areas, twice per week.
- Apply appropriate weed control sprays and hand weed as required to maintain planting areas, native grassing bed areas, turfed areas, paved areas, and tree pits in turf free of weed or rogue grass growth.
- Regularly tidy and top up mulch and trim edges to prevent spill over onto paved / grassed areas.
- Spray to control pests and diseases.
- Replace plants, which fail with plants of a similar size and quality as originally specified to approval of Superintendent. Costs of replacement shall be the responsibility of the Contractor. Replacement planting will be undertaken within 2 weeks of identification of dead material or instruction be the Superintendent.
- Report any incidence of plants stolen or destroyed by vandalism.
- Adjust stakes and ties to plants as necessary. Ensure that strangulation of plants does not occur.
- Prune and shape plants as directed or where necessary.
- Make good any defects or faults arising out of defective workmanship or materials.
- Fertilise lawn areas to maintain healthy growth.
- Make good any erosion or soil subsidence, which may occur including soft areas in pathways.
- Mow lawn to maintain neat healthy growth.
- A final inspection shall be made by the Superintendent before handover. Any items requiring rectification shall be repaired before the works are finally approved, and retention moneys released.

NOTE:

- All finished levels are to be verified by Contractor on site.
- All landscape works be in strict accordance with Council's landscape code and guidelines
- This plan to be used in conjunction with all other submitted architectural, hydraulics and engineering drawing where applicable.

| GREENLAND DESIGN | Jan | Feb | Mar | Apr | May | Jun | Jul | Aug | Sep | Oct | Nov | Dec |
|---|-----|-----|-----|-----|-----|-----|-----|-----|-----|-----|-----|-----|
| TWELVE MONTHS MAINTENANCE SCHEDULE | | | | | | | | | | | | |
| Plant Care | | | | | | | | | | | | |
| Monitoring | | | | | | | | | | | | |
| Pruning as required | | | | | | | | | | | | |
| Deadhead / tip pruning | | | | | | | | | | | | |
| Slow release fertilise | | | | | | | | | | | | |
| Rapid soluble fertilise as required | | | | | | | | | | | | |
| Cut back perennials and grasses | | | | | | | | | | | | |
| Watering as required | | | | | | | | | | | | |
| Garden Bed | | | | | | | | | | | | |
| Edging | | | | | | | | | | | | |
| Remove weeds and herbicide spraying as required | | | | | | | | | | | | |
| Top up mulch as required | | | | | | | | | | | | |
| Dead foliage removal | | | | | | | | | | | | |
| Pest Management | | | | | | | | | | | | |
| Monitoring and herbicide spraying as required | | | | | | | | | | | | |
| Turfed Area | | | | | | | | | | | | |
| Fertilise | | | | | | | | | | | | |
| Make good turf as required | | | | | | | | | | | | |
| Winter clean up | | | | | | | | | | | | |
| Remove dead foliage and pruning as required | | | | | | | | | | | | |



LOCKED BAG 5022
PARRAMATTA NSW 2124
PHONE No 1800 738 718
https://www.dpie.nsw.gov.au/land-and-housing-corporation

NOMINATED ARCHITECT:

Barry Rush & Associates Pty Ltd
Architects
Suite 25A, 2 Beattie Street, Balmain NSW, 2041
Phone: (612) 9555 8028 Fax: (612) 9810 0161
Email: info@barryrush.com.au
www.barryrush.com.au

| | | |
|--|------------|------------------------------------|
| F | 02/06/2022 | DISH DRAIN AND OVERFLOW PATH ADDED |
| E | 16/02/2022 | SOUTHERN SWALES ADDED |
| D | 03/11/2021 | PART 5 REVISION |
| C | 25/10/2021 | PART 5 RE-ISSUED |
| B | 04/05/2021 | FOR TENDER |
| REV | DATE | NOTATION/AMENDMENT |
| DO NOT SCALE DRAWINGS, CHECK ALL DIMENSIONS ON SITE. FIGURED DIMENSIONS TAKE PRECEDENCE. | | |

| | |
|-----------------------|--|
| PROJECT MANAGER | LAND & HOUSING CORPORATION PH (02) 8753 8000 FAX (02) 8753 8888 |
| STRUCTURAL CONSULTANT | |
| MECHANICAL CONSULTANT | |

| | |
|-----------------------|---|
| HYDRAULIC CONSULTANT | |
| ELECTRICAL CONSULTANT | |
| LANDSCAPE CONSULTANT | GREENLAND DESIGN PTY LTD PH 0403 164 188 |

| | |
|----------|---|
| PROJECT: | SENIORS DEVELOPMENT 21-23 PHILLIPS AVENUE & 5 RICHARDSON AVENUE REGENTS PARK LOTS 53, 54 & 55 IN DP35559 |
|----------|---|

| | |
|--------|-------------------------------------|
| TITLE: | LANDSCAPE DETAILS AND SPECIFICATION |
| FILE: | 2227 |

| | |
|-----------------|-----------------|
| STATUS: | PART 5 APPROVAL |
| DATE: | 02/06/2022 |
| SCALE: | 1:100 |
| PROJ: | - |
| PROJECT NO: | BGFJ2 |
| SHEET: | PART 5 |
| DRAWN: | CL |
| CHECKED: | GD |
| LANDSCAPE ARCH: | |
| TYPE: | LA |
| SHEET: | 2 of 2 |
| REV: | F |